

DHI-ARM320-W2(868)

Dahua Wireless Input Expander



- Six types of alarms: Intrusion, medical, fire, emergency, gas, and tamper.
- Connects to external power supplies.
- Triggers alarms when the device is moved.
- Alarms go off when the device overheats.
- Cloud update.
- The two-way wireless encrypted communication mechanism improves the security and stability of communication.
- With the wireless frequency hopping mechanism, the device automatically hops to other available frequency bands when the original frequency band is being interfered with by other wireless radios, to ensure communication remains smooth.

System Overview

The Wireless Input Expander is a conversion device that connects third-party detectors to Dahua Wireless Hub. When the alarm of the third-party detector is triggered, the Expander sends the signal to the Hub through RF, and then the Hub reports it to platforms. Different alarm types can be configured on the DMSS app, depending on the types of connected detectors. The expander has a triaxial accelerometer in it to prevent the device from movement. An input channel is also provided to connect the tamper port of the third-party detectors. The Expander is powered by dry batteries, and can also provide power supply for detectors connected to it.

Technical Specification

| Port | |
|-------------------------------|---|
| Alarm Input | 2 (1 for alarm and 1 for anti-tampering) |
| Auxiliary Power Output | 3.3 V, up to 10 mA |
| Function | |
| Button | 1 × power button |
| Remote Update | Cloud update |
| Low Battery Detection | Yes |
| Tamper | Yes |
| Measuring Range (Temperature) | -10 °C to +55 °C (+14 °F to +131 °F) (indoor) |
| Technical | |
| Sensor | Triaxial accelerometer |
| LED Indicator | 1 × green alarm indicator |
| Scenario | Indoor |

| Operating Current | 45 uA (with 1 min heartbeat, normally open mode, charge not being provided for other devices and device moved alarm not enabled) |
|-------------------------|--|
| Alarm Current | 50 mA |
| Wireless | |
| Carrier Frequency | 868.0 MHz–868.6 MHz |
| Communication Mechanism | Two-way |
| Communication Distance | Up to 1600 m (5249.34 ft) in an open space |
| Encryption Mode | AES128 |
| Frequency Hopping | Yes |
| General | |
| Power Supply | 3 × CR123A battery |
| Battery Model | CR123A |
| Battery Life | 5 years (4 years if the external input type is pulse) |
| Power Consumption | Max. 150 mW (without providing charge for other devices) |
| Operating Temperature | -10 °C to +55 °C (+14 °F to +131 °F) (indoor) |
| Operating Humidity | 10%–90% (RH) |
| Product Dimensions | 102 mm × 39 mm × 21.5 mm (4.02" × 1.54" × 0.85") |
| Net Weight | 77 g (0.17 lb) |
| Gross Weight | 135 g (0.30 lb) |
| Installation | Surface mount, or mount inside a third-party device |
| Certifications | CE |
| Anti-corrosion Level | Basic Protection |
| Packaging Dimensions | 95 mm × 43 mm × 139 mm (3.74" × 1.69" × 5.47") |

Installation

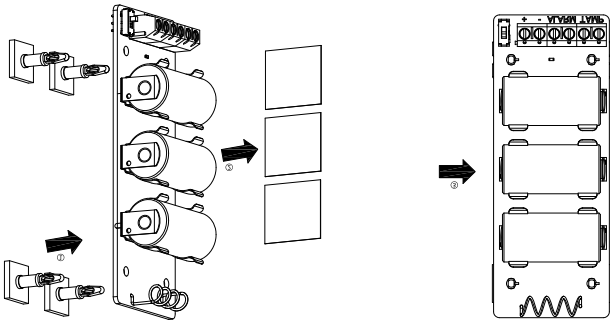

Dimensions (mm/inch)

