

Sealed maintenance-free lead-acid batteries series DTS ASTERION brand are manufactured by AGM technology (electrolyte absorbed in glass fiber separators) and equipped with VRLA valves.

Due to a wide range of batteries and their high performance, are recommended for use in a variety of uninterruptible power supply systems, including exacting electrical appliances (submersible and circulation pumps, boilers of heating systems), emergency power supply and other electrical devices.

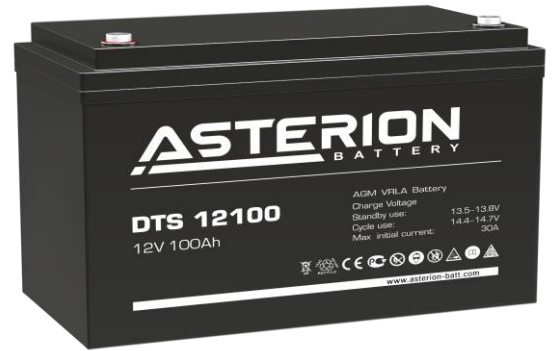

Battery construction

Element	Positive plate	Negative plate	Case	Lid	Valve	Terminal	Separator	Electrolyte
Material	Lead dioxide	Lead	ABS		Rubber	Copper	Fiberglass	Acid

Specifications

Nominal voltage.....12 V
 Cell.....6
 Design life.....10 years
 Nominal capacity (25°C)
 20 hours rate (5 A; 1,75 V/cell).....100 Ah
 10 hours rate (9,6 A; 1,75 V/cell).....96 Ah
 5 hours rate (17,2 A; 1,70 V/cell).....86 Ah
 Self-discharge.....3% capacity per month 20°C
 Internal resistance (25°C).....4,5 mΩ

Operating temperature range

Discharge..... -10÷40°C
 Charge..... -20÷60°C
 Storage..... -20÷60°C
 Maximum discharge current (25°C).....900A (5sec)
 Cycle mode (2,4÷2,45 V/cell)
 Max.charge current.....30 A
 Temperature correction factor.....30 mV/°C
 Standby mode (2,25÷2,3 V/cell)
 Temperature correction factor.....20 mV/°C

Application

- Uninterruptable power supply
- Back up power supply
- Space-heating system
- Renewable energy systems

Performance & characteristics

- AGM technology allows to recombine 99% of the generated gas;
- No restrictions on air transportation;
- Compliance with the UL requirements;
- Lead plates, alloyed by calcium, provide high energy density;
- Maintenance-free. Do not require distillate topping;
- Long service life;
- The battery case is made of flame-retardant ABS

Dimensions (±2mm)

Length, mm.....330
 Width, mm.....173
 Height, mm.....216
 Height over terminals, mm.....222
 Weight (±3%), kg.....28

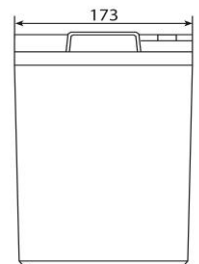
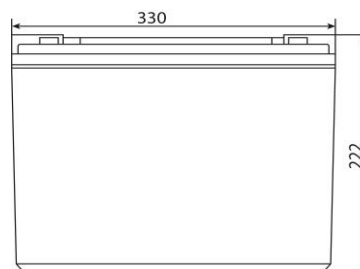

Layout B



Terminal type
Insert Ø6 mm

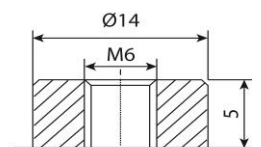
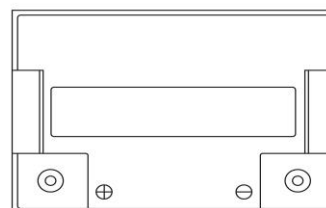
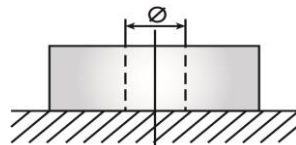

Discharge Constant Current, A (25°C)

V/cell	5 min	10 min	15 min	30 min	1 h	3 h	5 h	10 h	20 h
1,60	292	208	171	99,2	58,1	25,8	17,3	9,82	5,25
1,65	276	200	163	96,9	57,7	25,7	17,1	9,70	5,18
1,70	245	178	147	88,6	57,2	25,5	17,0	9,60	5,06
1,75	228	166	138	86,3	56,7	25,4	16,9	9,52	5,00
1,80	211	157	133	84,4	53,9	23,8	16,3	9,40	4,90

Discharge Constant Power, W/cell (25°C)

V/cell	5 min	10 min	15 min	30 min	1 h	3 h	5 h	10 h	20 h
1,60	530	381	315	189	113	49,1	34,5	19,7	10,2
1,65	511	378	310	182	108	48,4	33,9	19,5	10,2
1,70	472	349	293	168	103	47,9	33,2	19,3	10,1
1,75	448	335	277	164	101	47,0	32,8	19,1	9,99
1,80	425	317	267	161	99,8	45,4	32,0	18,9	9,70

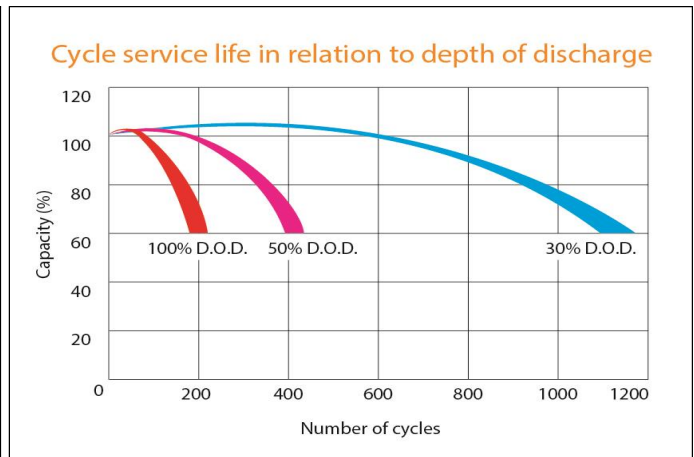
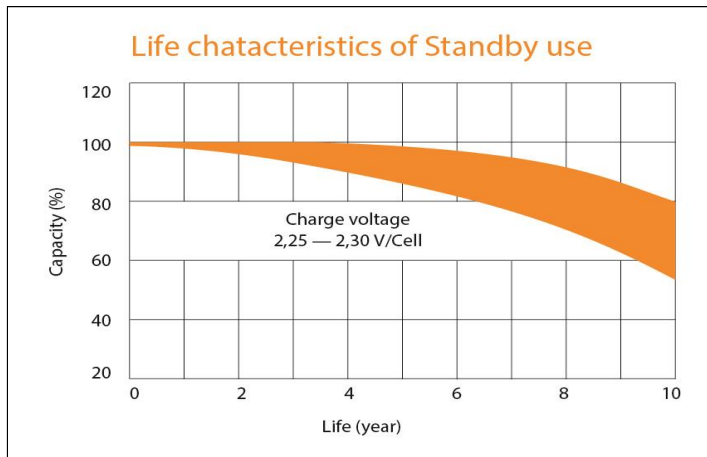
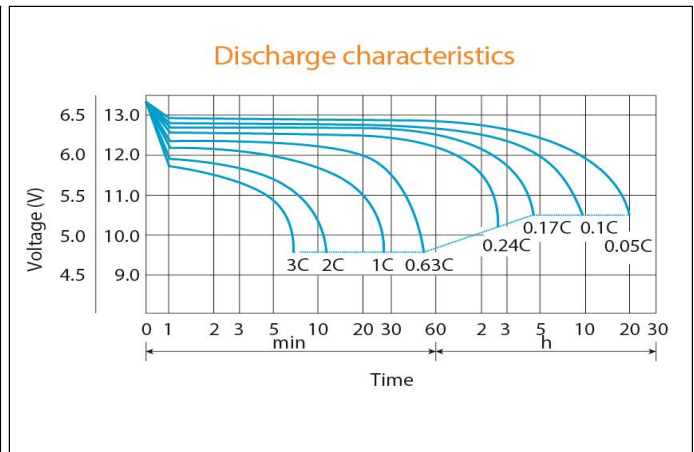
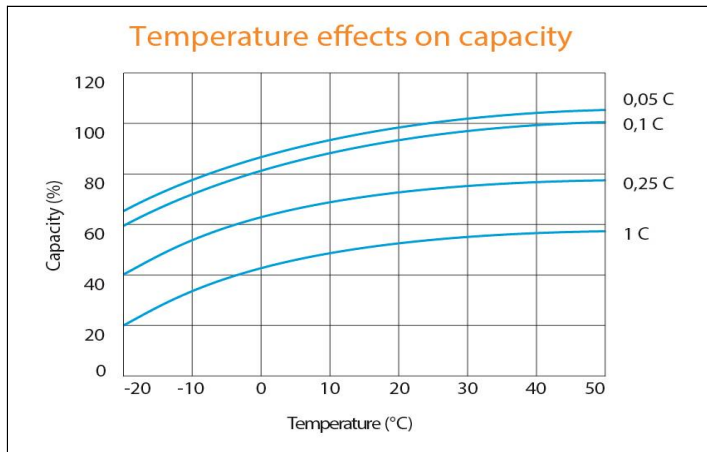

ALL DATA IS SUBJECT TO CHANGE WITHOUT NOTICE