

# SW165-8

## Securi-Prod Outdoor No-Touch Sensor

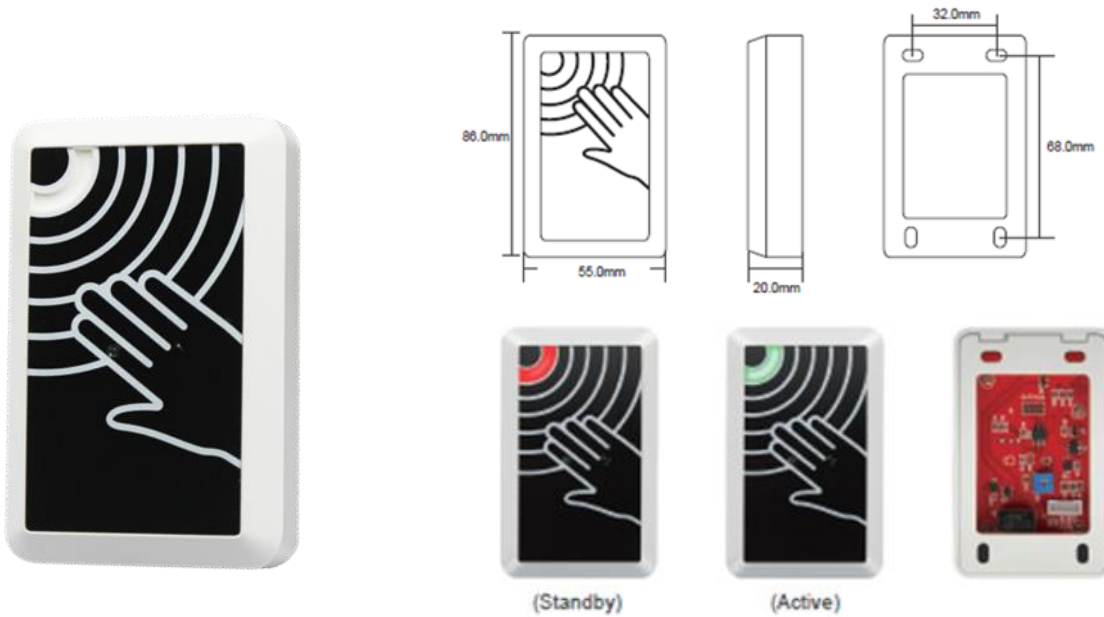

### Technical specification

Operating voltage:	12/24VDC
Material	PC case + ABS face plate
Colour	White
Output	NO/NC
Red	Standby
Green	Active
Sensitive distance	3-15cm (adjustable)
Ingress protection	IP68
Dimensions	86 (L) x 55 (W) x 20 (H) mm