

DOMESTIC RANGE - WITH EZI-MOUNT BRACKET

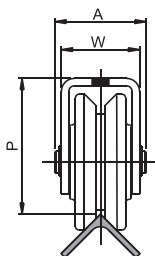

V - WHEEL ON ANGLE TRACK

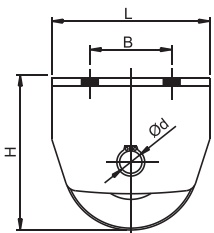
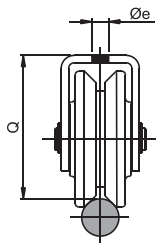

RADIUS WHEEL ON Ø16 ROUND TRACK

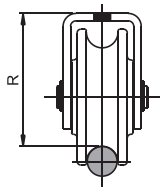

V - WHEEL ON Ø20 ROUND TRACK

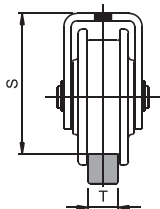

SQUARE TRACK WHEEL

EASY TO INSTALL, SEE NEXT PAGE FOR INSTALATION TIPS.

SERIES	ORDER CODE	L	H	W	Ød	Øe	A	B	P	Q	R	S	T	BEARING	MAX. LOAD PER GATE Kg's
40	WK40	65	55	42	12	9	50	44	49	51	-	-	-	6201 ZZ	300
60	WK60		61						52	56	53	53	16		500
80	WK80	82	73						77	63	75	800			

SUPPLIED IN KIT FORM CONSISTING OF :- 2 x WHEEL ASSEMBLIES PLUS 2 x ROLLER GUIDES.

WHEN ORDERING ELECTROPLATED WHEELS USE SUFFIX --/E

WHEN ORDERING RADIUS WHEELS USE SUFFIX --/R

WHEN ORDERING SQUARE TRACK WHEELS USE SUFFIX --/S

INFORMATION SUBJECT TO CHANGE WITHOUT PRIOR NOTICE

ROLLER GUIDE - (UV STABILIZED)

MAXIMUM LOAD CAPACITIES ARE BASED ON MAX. STATIC BEARING LOADS AND ARE INTENDED AS A GUIDE TO ASSIST THE INSTALLER.

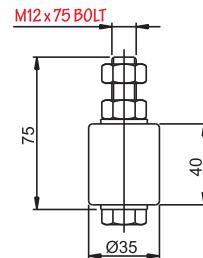

GUIDE ASSEMBLY

75% BETTER Wear Life

ROLLAWAY WHEELS ARE SUPERIOR. MANUFACTURED FROM CERTIFIED 080 M40 (EN8) MEDIUM CARBON STEEL THEY DELIVER:

- 54% BETTER YIELD STRESS
- 49.5% IMPROVED BRINELL HARDNESS

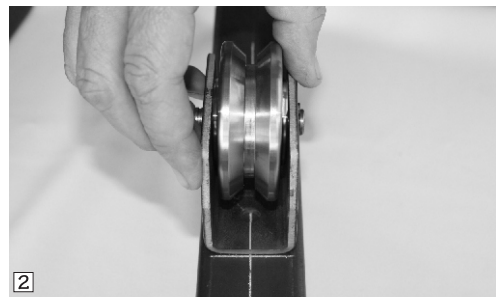

HEAVY DUTY RANGE - WITH SLIM-LINE BRACKET

75% BETTER
Wear Life

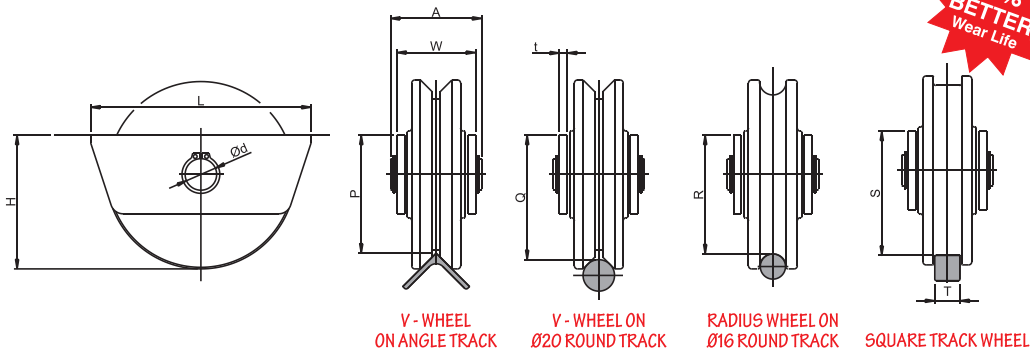

V - WHEEL
ON ANGLE TRACK

V - WHEEL ON
Ø20 ROUND TRACK

RADIUS WHEEL ON
Ø16 ROUND TRACK

SQUARE TRACK WHEEL

SEE NEXT PAGE FOR INSTALATION TIPS.

SERIES	ORDER CODE	L	H	W	Ød	t	A	P	Q	R	S	T	BEARING	MAX. LOAD PER GATE Kg's
100	WK100	140	75	42	12	4	50	65	69	66	69	16	6201 ZZ	800
100HD	WK100HD			50	20	5	58							
120	WK120	85						75	79	76	79			1800

SUPPLIED IN KIT FORM CONSISTING OF :- 2 x WHEEL ASSEMBLIES PLUS 2 x ROLLER GUIDES.
WHEN ORDERING ELECTROPLATED WHEELS USE SUFFIX --/E
WHEN ORDERING RADIUS WHEELS USE SUFFIX --/R
WHEN ORDERING SQUARE TRACK WHEELS USE SUFFIX --/S

INFORMATION SUBJECT TO CHANGE
WITHOUT PRIOR NOTICE

ASSEMBLY INSTRUCTIONS

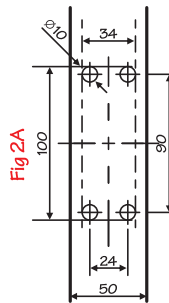

Fig 2A

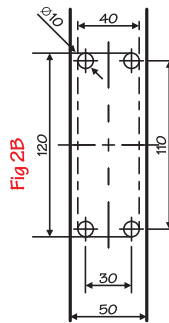

Fig 2B

DRILLING PATTERN FOR 100MM HD WHEEL AND 120MM WHEEL

DRILLING PATTERN FOR 100MM WHEEL



1 MARK OFF AND DRILL FOUR DIAMETER 10MM HOLES AS PER RECOMMENDED DRILLING PATTERN. SEE FIG 2A OR 2B

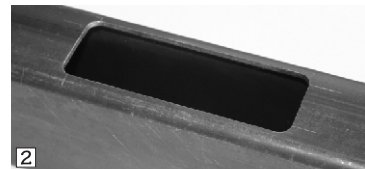

2 REMOVE CUT-OUT AND TRIM EDGES

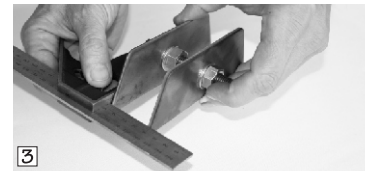

3 USING A PIECE OF THREADED ROD OR SIMILAR (NOT SUPPLIED), SET UP SIDE PLATES AS PER ABOVE. MAKE SURE SIDE PLATES ARE SQUARE TO EACH OTHER



4 ALIGN SIDE PLATES OVER CUT-OUT AND TACK INTO POSITION



5 THE WHEEL DEAL

ROLLAWAY
WHEELS ARE SUPERIOR.

