

# THE POWERLINE SERIES

## Office-light 2000 with 16Amp plug (Dedicated plugs)

12-00009

rev\_1

### Features

- Easy installation
- Failsafe protection
- Power filter

Plug-and-play protection for sensitive electronic equipment. The OFFICE-LIGHT 2000 automatically disconnect the power to the equipment in the event of damage to the protection element or power overload. Suitable for electronic and electrical equipment. This unit has an ON/OFF switch incorporating a circuit breaker and power on Indicator. EMI/RF filtration has been included.

Protects fast ethernet LAN equipment such as network interface cards from induced lightning and electrostatic discharge.

Supports the compliment of 100Base-T configurations:  
100Base-TX, 100Base-T4 and 100Base-VG.

Backwards compatible to 10Base-T



Specification	
<b>Power</b>	
Max. continuous voltage	275Vac 50Hz
Max continuous current	16A
Earth Leakage	<1.5mA
Max. discharge current(8/20)	8kA
Response time	<25ns
Filtration at 100kHz	50dB
Standards Compliancen	IEC 99.4, IEC 950, IEC 61643-1
<b>Network</b>	
Max.discharge current (8/20)	2.5kA
Residual voltage ( Differential mode)	<25V
Residual voltage ( Common mode)	<100V
Data speed	100Mbps
Connector	RJ45
Pairs protected	1-2, 3-6

### Dimension

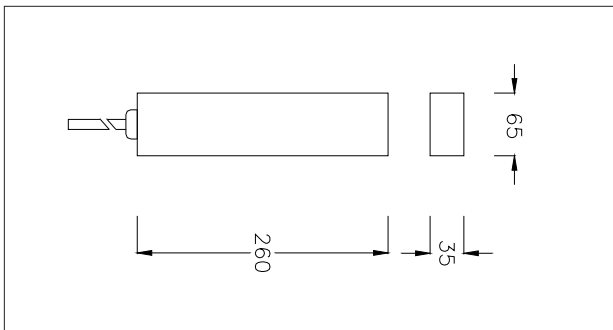

### Designed and Manufactured by:

#### Clearline Protection Systems (Pty) Ltd

385 Roan Crescent Corporate Park North, Old Pta Road,

Midrand, South Africa

P.O. Box 5985, Halfway House, 1685

Tel: +27 (0) 11 848-1100

Fax: +27 (0) 11 314-3880

E-mail: [info@clearline.co.za](mailto:info@clearline.co.za)

[www.clearline.co.za](http://www.clearline.co.za)

