

24-Port Gigabit IEEE 802.3at PoE+ Managed Injector Hub (440 watts)

PLANET POE Managed PoE Injector Hub series, a cost-effective and quick PoE solution, is designed to perfectly upgrade an existing network infrastructure to IEEE 802.3at Power over Ethernet Plus network system without replacing the existing Ethernet Switch.



A Perfect Managed PoE+ Injector Hub

With PoE in great demand, the IEEE 802.3af standard is being replaced by IEEE 802.3at (also known as PoE Plus) Type 1. PLANET new POE-2400G is specifically designed to support 802.3at PoE+. The POE-2400G is a high-density, rack-mountable managed PoE+ injector hub featuring PLANET intelligent PoE functions through web user interface for remote management. As its name implies, the unit can inject a total PoE budget of 440 watts into PDs. Its 24 10/100/1000BASE-T Ethernet ports can each deliver up to 36 watts of power over Cat.5/5e/6 Ethernet UTP cables which allow data and power to transmit simultaneously to remote 802.3at/af powered devices (PDs).

Quick and Easy PoE Network Deployment

The POE-2400G is installed between a regular Ethernet Switch and the PDs. There are totally 48 RJ45 STP ports on the front panel of the POE-2400G, of which the 24 ports are on the lower stack functioned as "Data input" while the other 24 ports are on the upper stack functioned as "PoE (Data and Power) output". Both power and data are transferred simultaneously over the UTP cables to PDs without affecting the existing network performance and functions.

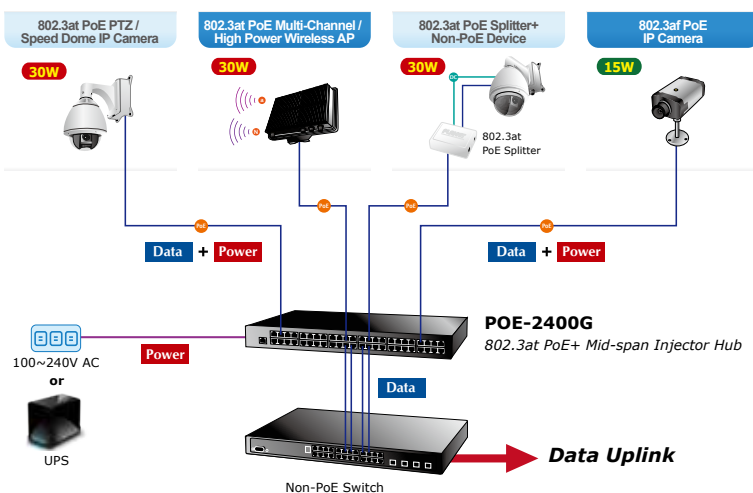

Interface

- Complies with the IEEE 802.3, IEEE 802.3u and IEEE 802.3ab Ethernet standard
- 48-port RJ45
 - 24-port 10/100/1000Mbps "Data input"
 - 24-port 10/100/1000Mbps "Data + Power output"
- One 10/100/1000BASE-T management port

Power over Ethernet

- Complies with IEEE 802.3at and IEEE 802.3af Power over Ethernet mid-span PSE
- Up to 24 IEEE 802.3at/802.3af devices powered
- 440-watt PoE budget
- Supports PoE power up to 30.8 watts (802.3at PoE)/15.4 watts (802.3af PoE) for each PoE port
- Automatically detects powered device (PD)
- Circuit protection prevents power interference between ports
- Remote power feeding up to 100m

PoE Management

- Total PoE power budget control
- Per port PoE power schedule
- PoE function enable/disable
- Per port PoE function enable/disable
- PoE port power feeding priority
- PD classification detection
- Over temperature protection
- PD alive-check

Management

- Web interface for remote management
- Supports Network Time Protocol (NTP)
- Firmware upgrade through Web interface
- PLANET Smart Discovery utility automatically finds PLANET devices on the network
- SNMP trap for alarm notification of events
- System log/remote syslog

Hardware

- 19-inch rack mountable; 1U height
- Reset button for resetting to default setting and system reboot
- LED indicators for PoE ready and PoE activity
- LED indicators for power alert and fan alert
- FCC Part 15 Class A, CE

With data and Power over Ethernet from one unit, the POE-2400G can reduce power cable deployment and eliminate the need for dedicated electrical outlets on the wall, ceiling or any unreachable place.

IEEE 802.3at PoE+ Standard Compliance

The PoE in-line power adopting the IEEE 802.3at Power over Ethernet Plus standard makes the POE-2400G able to deliver per port up to 36 watts of power to each remote PoE compliant powered device. It possesses double amount of power capability than the conventional 802.3af PoE and is an ideal solution to satisfy the growing demand for higher power consuming network PDs, such as PTZ (Pan, Tilt and Zoom), speed dome network cameras, color touch-screen or video and voice over IP (VoIP) telephones, multi-channel 802.11ac wireless LAN access points and other network devices.

PTZ / Speed Dome Camera

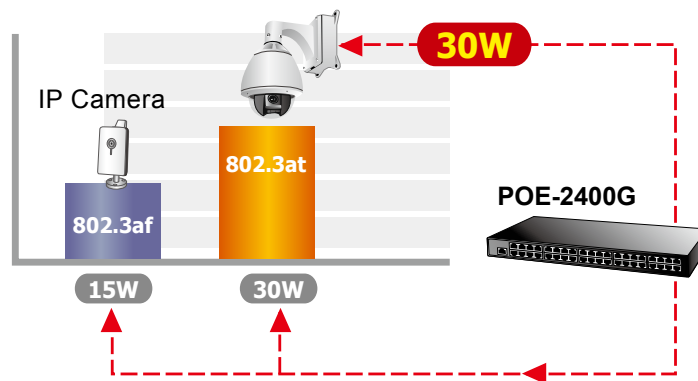

Friendly Web Management Interface

To efficiently manage the powered devices, the POE-2400G provides simple Web management interface in which administrators can control the system and PoE functions for powered devices. It can automatically detect the power status of each port and show messages on its Web management interface. These features also provide users with a cost-effective way to manage the device via Internet whenever they are at work or at home.

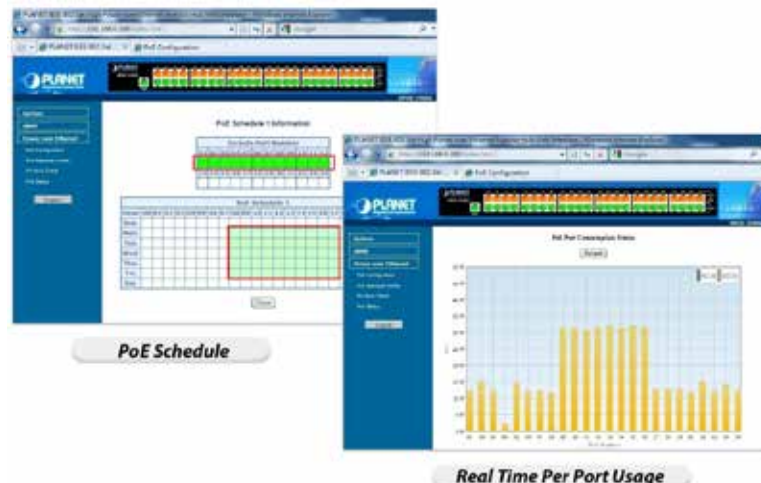

Built-in Unique PoE Functions for Powered Device Management

As it is the managed PoE Injector Hub for VoIP, wireless and surveillance networks, the POE-2400G features the following special PoE management functions:

- PoE schedule
- PD alive check
- Scheduled power recycling
- PoE usage monitoring
- Over temperature protection

Intelligent Powered Device Alive Check

PLANET's Managed PoE products adopt not only Power over Ethernet technology, but also automated PD monitoring and real-time PoE status. The POE-2400G can be configured to monitor connected PD's status in real time via ping action through the uplinked Ethernet switch. Once the PD stops working and responding, the POE-2400G will recycle the PoE port power and bring the PD back to work. It also will greatly enhance the network reliability in that the PoE port will reset the PD power, thus reducing administrator's management burden.

PoE PD Alive Checking

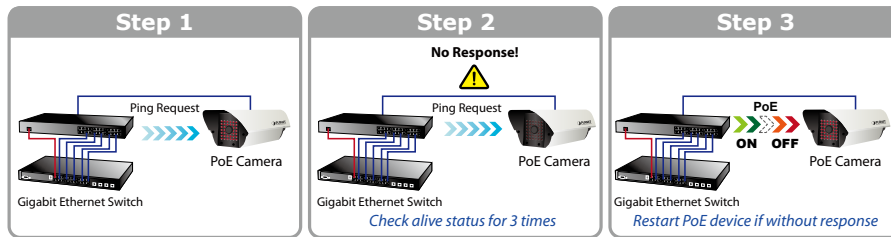

PoE Schedule for Energy Saving

Under the trend of energy saving worldwide and contributing to environmental protection on the Earth, the POE-2400G can effectively control the power supply besides its capability of giving high watts power. The built-in "PoE schedule" function helps you to enable or disable PoE power feeding for each PoE port during specified time intervals and it is a powerful function to help SMBs or enterprises save power and money.

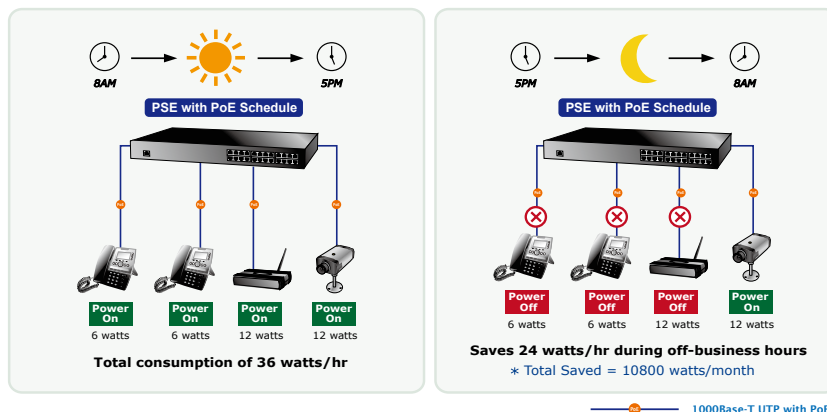

Advanced Power Management

To facilitate power management, the POE-2400G comes with powerful PoE management features such as over temperature protection, usage threshold alert and auto power allocation to prevent power budget overloading. The PoE power budget can be allocated by priorities or classification and sent alert event logs when power usage reaches the defined threshold.

PoE Usage Monitoring

Via the power usage chart in the web management interface, the POE-2400G enables the administrator to monitor the status of the power usage of the connected PDs in real time. Thus, it greatly enhances the management efficiency of the facilities.

High Power Budget for PoE Extension

With 36-watt PoE output capability, the POE-2400G can extend much longer distance by using PLANET PoE Extender for powering up the PoE PD which can be installed over more than 100 meters away. By daisy-chaining multiple PLANET PoE Extenders, it offers the great flexibility of doubling, tripling or quadrupling the distance of PoE network.

Smart Fan Design for Silent Operation

The POE-2400G features a low noise design and an effective ventilation system. It supports the smart fan technology that automatically controls the speed of the built-in fan to reduce noise and maintain the temperature of the PoE injector hub for optimal power output capability. The POE-2400G is able to operate reliably, stably and quietly in any environment without affecting its performance.

Applications

Gigabit PoE Network Deployment

The POE-2400G provides the easiest way to power your Ethernet devices such as IP camera on the ceiling and the wireless access point installed on the top of the building. With 24 10/100/1000BASE-T Gigabit Ethernet ports, the POE-2400G supports full 52V DC power for any remote IEEE 802.3af/802.3at powered device (PD).

To control the power system of your networking devices, the POE-2400G can directly co-work with PoE IP phone to build VoIP telephony network in the office. Furthermore, the POE-2400G can be directly connected to any third-party IEEE 802.3af/802.3at compliant devices installed within 100 meters.



Specifications

| | | |
|---|--|--|
| Product | POE-2400G | |
| Hardware | | |
| Hardware Version | 4 | |
| Interface | “Data” Input Ports | 24 x RJ45 |
| | “Data+Power” Output Ports | 24 x RJ45 |
| | Management Port | 1 x RJ45; 10/100/1000BASE-T, auto-negotiation, auto-MDI/MDIX |
| Data Rate | 10/100/1000Mbps | |
| LED | System: SYS PWR x 1 (green) PoE1 Failure x 1 (red) PoE2 Failure x 1 (red) Fan1 Failure x 1 (red) Fan2 Failure x 1 (red) Per PoE Port: PoE-in-use x 1 (green) Management port x 2: 1000 (green), 10/100(orange) | |
| Network Cable | 10BASE-T: 4-pair UTP Cat5 up to 100m (328ft) 100BASE-TX: 4-pair UTP Cat5 up to 100m (328ft) 1000BASE-T: 4-pair UTP Cat5e/6 up to 100m (328ft) EIA/TIA- 568 100-ohm STP (100m) | |
| Power Requirements | 100-240V AC, 50/60 Hz, 8A | |
| Power Consumption | 500 watts (max.) | |
| Ventilation | Fan x 3 | |
| Dimensions (W x D x H) | 440 x 300 x 44mm | |
| Power over Ethernet | | |
| PoE Power Supply Type | Mid-span | |
| PoE Power Output | Per port DC 52V 30.8/15.4 watts | |
| Power Pin Assignment | 4/5(-), 7/8(+) | |
| PoE Power Budget | 440 watts | |
| Number of 802.3af PDs (Class 0, 1, 2, 3) can be powered | 24 | |
| Number of 802.3at PDs (Class 1, 2, 3) can be powered | 14 | |
| Number of 802.3at PDs (Class 0, 4) can be powered | 14 | |
| Management | | |
| Management Interface | Web, PLANET Smart Discovery Lite | |
| PoE Management | Power limit by consumption and classification mode PoE admin mode Per port power schedule Per port power enable/disable Power feeding priority Over temperature protection Current per port usage and status Total power consumption | |
| Management Feature | Setup of system/management functions Web firmware upgrade SNMP trap for alarm notification of events | |
| Standards Conformance | | |
| Regulatory Compliance | FCC Part 15 Class A, CE | |
| Standards Compliance | IEEE 802.3 10BASE-T Ethernet IEEE 802.3u 100BASE-TX Fast Ethernet IEEE 802.3ab 1000BASE-T Gigabit Ethernet IEEE 802.3at Power over Ethernet Plus IEEE 802.3af Power over Ethernet RFC 768: UDP RFC 791: IP RFC 2068 HTTP RFC 1157: SNMP v1 RFC 1902: SNMP v2c RFC 5424: Syslog | |
| Environments | | |
| Operating | Temperature: 0 ~ 50 degrees C Relative Humidity: 5 ~ 90% (non-condensing) | |
| Storage | Temperature: -10 ~ 70 degrees C Relative Humidity: 5 ~ 90% (non-condensing) | |

Ordering Information

| | |
|-----------|--|
| POE-2400G | 24-Port Gigabit IEEE 802.3at PoE+ Managed Injector Hub (440 watts) |
|-----------|--|

Related PoE Products

| | |
|--------------|---|
| POE-1200G | 12-Port Gigabit IEEE 802.3at PoE+ Managed Injector Hub (220 watts) |
| HPOE-1200G | 12-Port Gigabit IEEE 802.3at PoE+ Managed Injector Hub (360 watts) |
| HPOE-2400G | 24-Port Gigabit IEEE 802.3at PoE+ Managed Injector Hub (720 watts) |
| ICA-2250VT | Industrial PoE Plus Outdoor IR IP Camera |
| ICA-2500 | 5 Mega-pixel PoE Box IP Camera |
| ICA-3250V | Full HD Outdoor IR PoE IP Camera |
| ICA-3350P | 3 Mega-pixel Remote Focus Bullet IR IP Camera |
| ICA-E3550V | 5 Mega-pixel Bullet IR PoE IP Camera with Extended Support |
| ICA-4200V | Full HD 20M IR Vari-focal Dome IP Camera |
| ICA-4500V | 5 Mega-pixel 20M IR Vari-focal Dome IP Camera |
| ICA-5250 | Full HD Ultra-mini Vandal Dome |
| ICA-HM351 | 2 Mega-pixel 35M IR Outdoor Box PoE IP Camera |
| ICA-HM620 | 2 Mega-pixel PoE Plus Speed Dome Internet Camera |
| POE-152S | IEEE 802.3af Power over Ethernet Splitter |
| POE-162S | IEEE 802.3at Gigabit High Power over Ethernet Splitter |
| POE-E101 | IEEE 802.3af Power over Ethernet Extender |
| POE-E201 | IEEE 802.3at Power over Ethernet Extender |
| WNAP-C3220 | 802.11n Wireless Ceiling-mount PoE Access Point |
| WNAP-W2200 | 802.11n 300Mbps In-Wall Access Point w/USB Charger (EU Type) |
| WDAP-1750AC | 1750Mbps 802.11ac Dual Band Wall-mount Enterprise Wireless Access Point |
| WDAP-C7200AC | 1200Mbps 802.11ac Dual Band Ceiling-mount Wireless Access Point |
| WDAP-W7200AC | 1200Mbps 802.11ac Dual Band Wall-mount Wireless Access Point |
| WDAP-C7400 | 900Mbps Dual Band Ceiling-mount Wireless Access Point |
| ICF-1800 | HD Touch Screen Android Multimedia Conferencing Phone |
| VIP-1010PT | High Definition PoE IP Phone (1-Line) |
| VIP-2020PT | Enterprise HD PoE IP Phone (2-Line) |
| VIP-5060PT | Professional HD PoE IP Phone (6-Line) |